

ART.3925 34

CHROME-PLATED STRAINER WITH BUILT-IN STOP COCK.

- Body, nut and connections material: CW617N brass
- Connections: male - female
- Sealing O-ring: EPDM
- Filtration mesh: AISI 304 steel
- Sealing seat: HPF
- Shutter: CW614N brass
- Spring: AISI 302 steel

1 DESCRIPTION AND INSTALLATION

When installed before a manifold, the FAR STRAINER guarantees perfect filtration of the water before it is distributed, thus preventing harmful particles that may cause malfunctions. Usually it is installed in domestic services between the ball valve and the manifold but it can also be installed in heating systems.

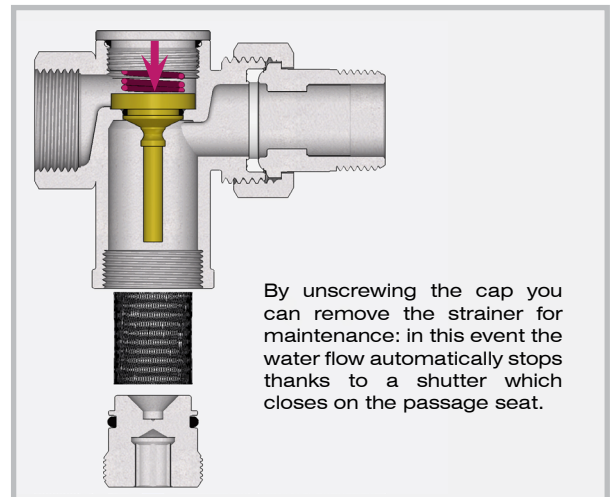
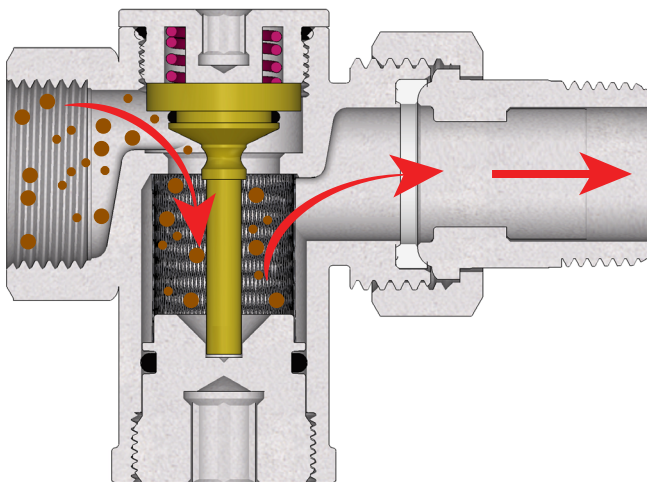

2 TECHNICAL FEATURES

Nominal pressure: 10 bar
 Max. temperature: 95°C
 Filtration level: 250 µm

3 DIMENSIONAL AND FLUID DYNAMIC FEATURES

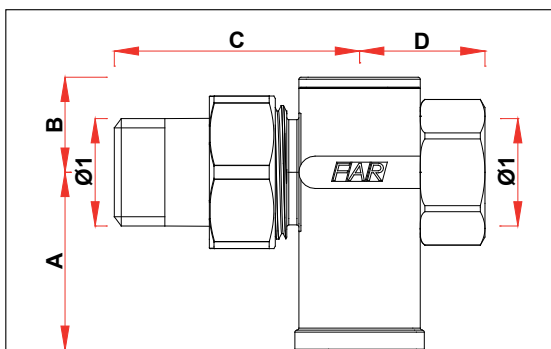

CODE	Ø1	A	B	C	D
3925 34	G3/4	44	24	60	31

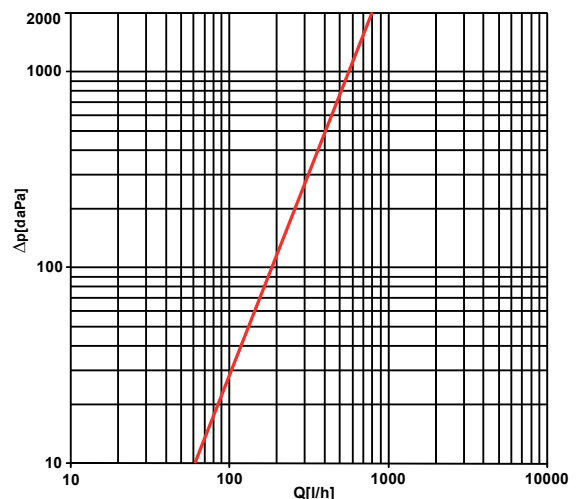

4 INSTALLATION OVERVIEW

In the installation example you can see a domestic service with inspection box. The latter consists of:

- Multifar manifolds, to exclude any single user.
- Water hammer arrester, able to protect the system from overpressure caused by the sudden opening and closing of a cock.
- FAR strainer to filter water and remove harmful particles.
- Ball valves, which allow you to exclude the entire delivery or return manifold.

The FAR strainer, Art.3925, is installed between the ball valve and the respective manifold as shown in the picture.

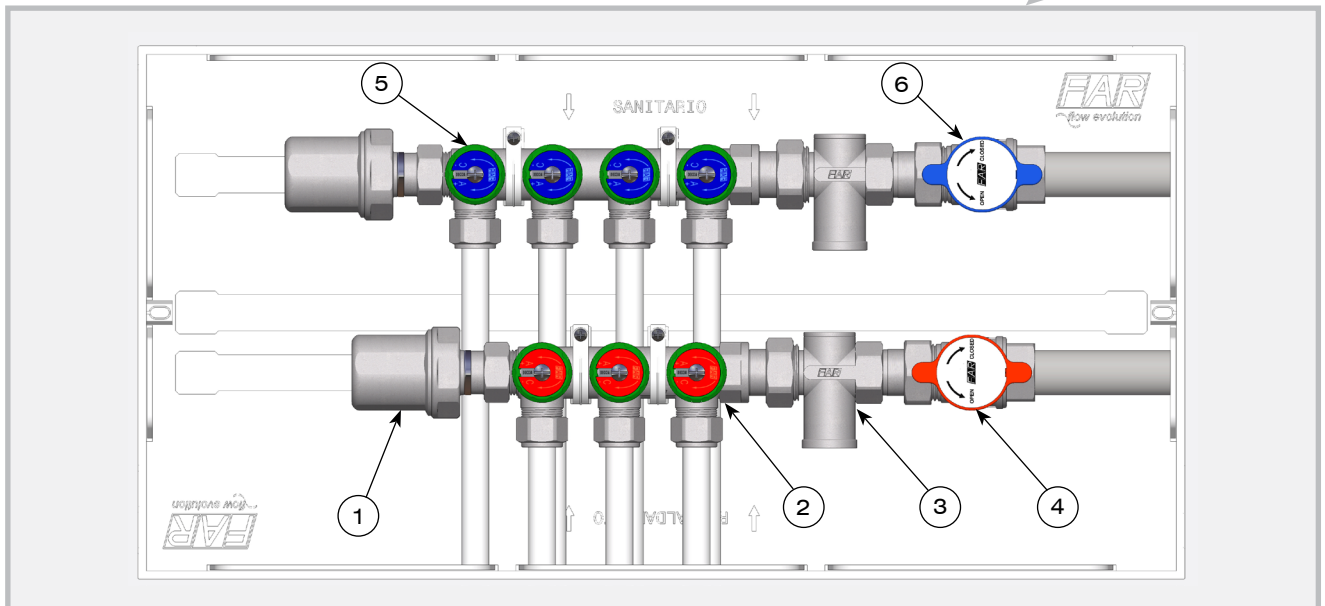
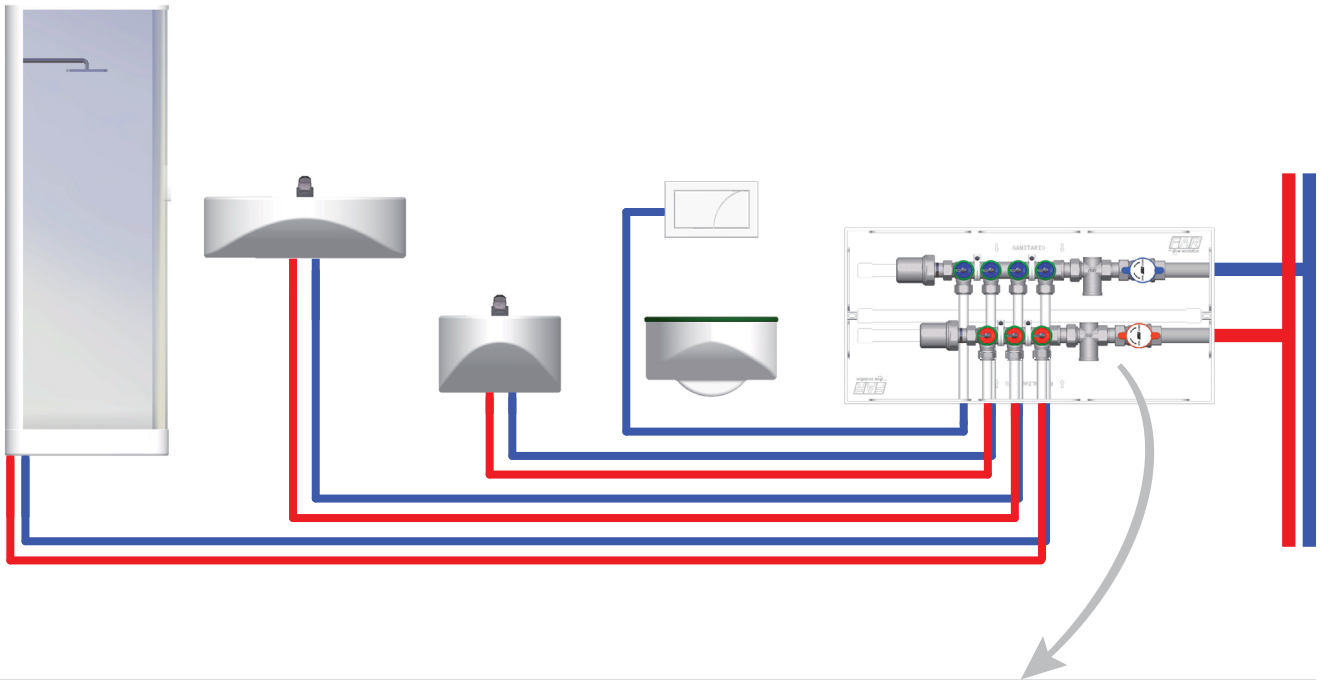

LEGEND

1. WATER HAMMER ARRESTER
2. 3-WAY MULTIFAR MANIFOLD FOR HOT DOMESTIC WATER
3. 1/4" FAR STRAINER
4. BALL VALVE WITH RED REGULATING HANDLE
5. 4-WAY MULTIFAR MANIFOLD FOR COLD DOMESTIC WATER
6. BALL VALVE WITH BLUE REGULATING HANDLE